



ECOCORE

ECOCORE consists of two struts that are mechanically engaged to the inner and outer aluminum frames. The struts are comprised of extruded polyamide 6.6 compound with glass fibres oriented in 3 axis. The geometry of the struts and the engagement are optimized to produce a frame that behaves as a COMPOSITE.

The STRUCTURALLY SUPERIOR frame is deeper than previous designs at 141mm (5 1/2"). The mechanical engagement of the outer parts to the ECOCORE results in maximum resistance to shearing forces, resulting in the ability to stand up to higher wind loads and to extend over larger spans.

The 38mm strut depth is 50% deeper than the competition. Improved THERMAL PERFORMANCE is measurable and ECOWALL, ECOCORE and high-performance glass are capable of achieving a U-Value of 0.34 BTU/hr-sq ft F

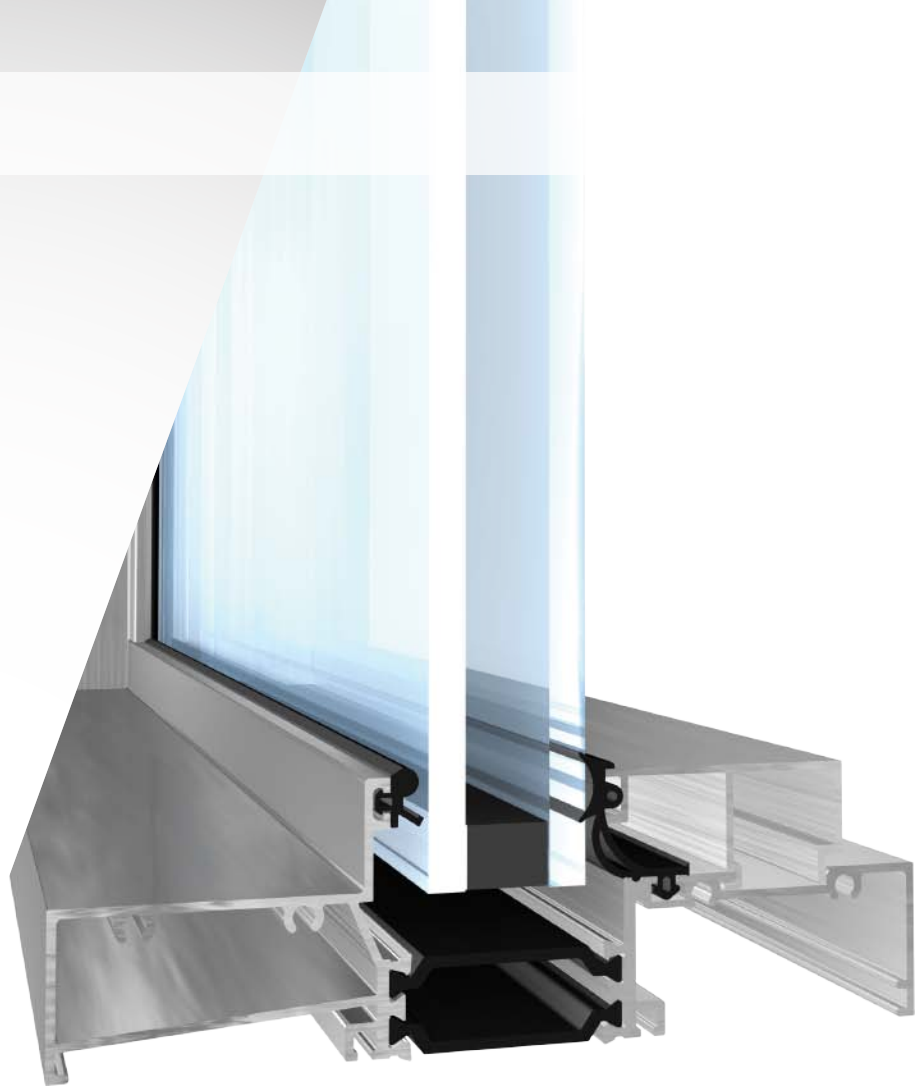

THE RIGHT SEAL, EVERYTIME.

ECOWALL utilizes an exterior dry gasket that is comprised of co-extruded EPDM and Foam. This combination of materials achieves a double seal between the outer frame and the insulated glass unit.

The interior seal features a Patent-Pending EPDM Dry Gasket that is engaged in two locations and mimics the geometry of a wet-sealant heal-bead. The interior gasket is held in place by an all-new aluminum stop that together can withstand a tested* wind load of over 400 km/hr

EPDM is a rubber compound (in place of plastic-based gaskets) and offers superior resistance to UV, and very low shrinkage rate.

*Testing Exceeded CSA 'C5' and reached up to 156PSF

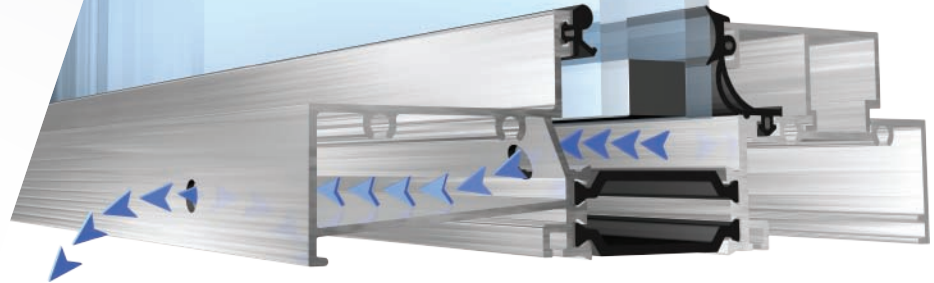

DRAIN-SCREEN

The design flexibility of ECOCORE enabled Quest to design ECOWALL based on a drain-screen principal. The Horizontal frame members feature an altered configuration of ECOCORE that creates a drainage cavity. This cavity along with a configuration of weep holes allow condensation to drain out the exterior of the system.

The interior dry Heal-Bead gasket in conjunction with the aluminum glass stop ensures that the primary interior seal is mechanically sound. This configuration has been tested to beyond CSA's highest B7 Rating. (14.6 PSF)*

*4 Cycles of 5 minutes on, 1 minute of relief.

Quest

FIXED WINDOW

HEAD, MULLION & SILL DETAILS

SECTION

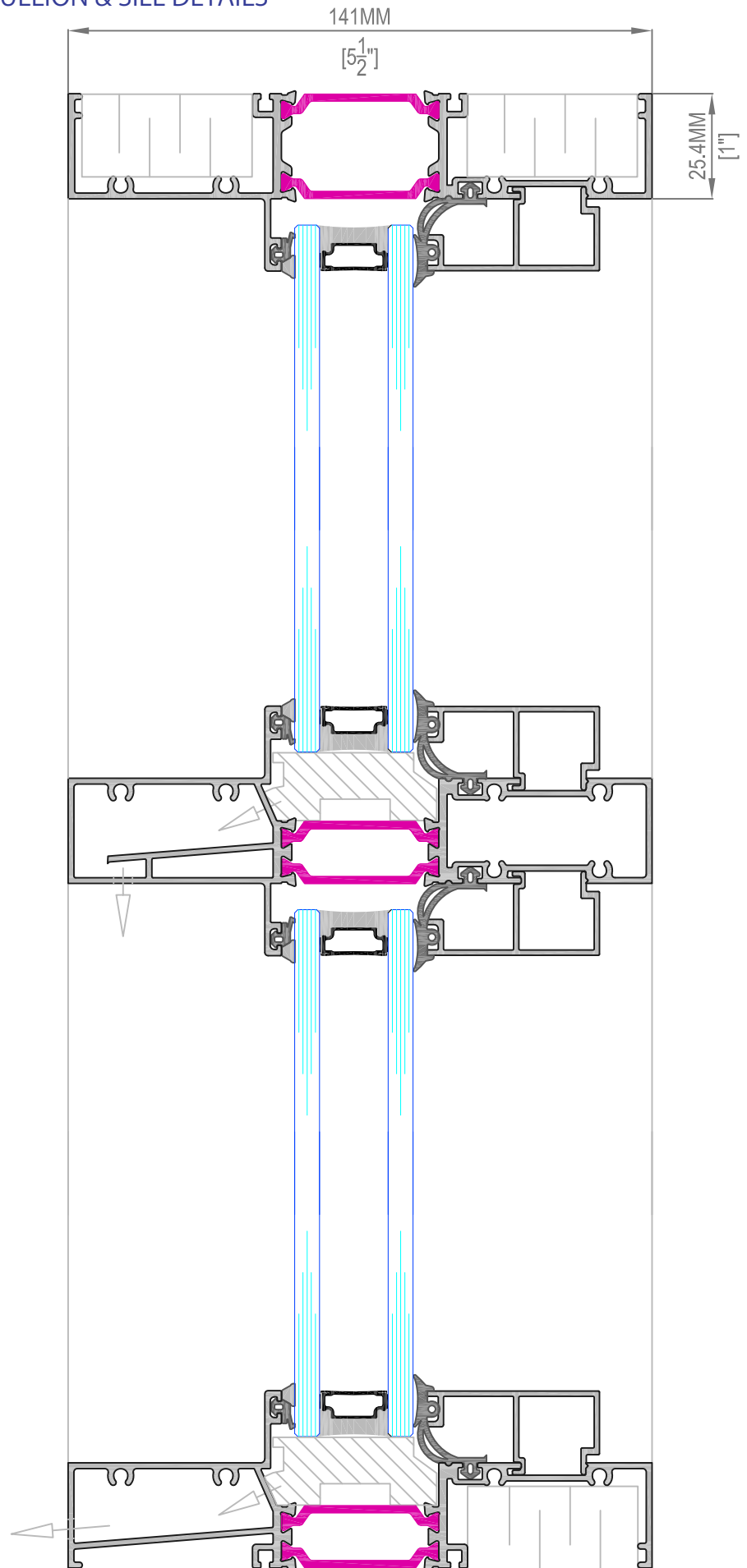

AWNING WINDOW

JAMB & COUPLER DETAILS

PLAN

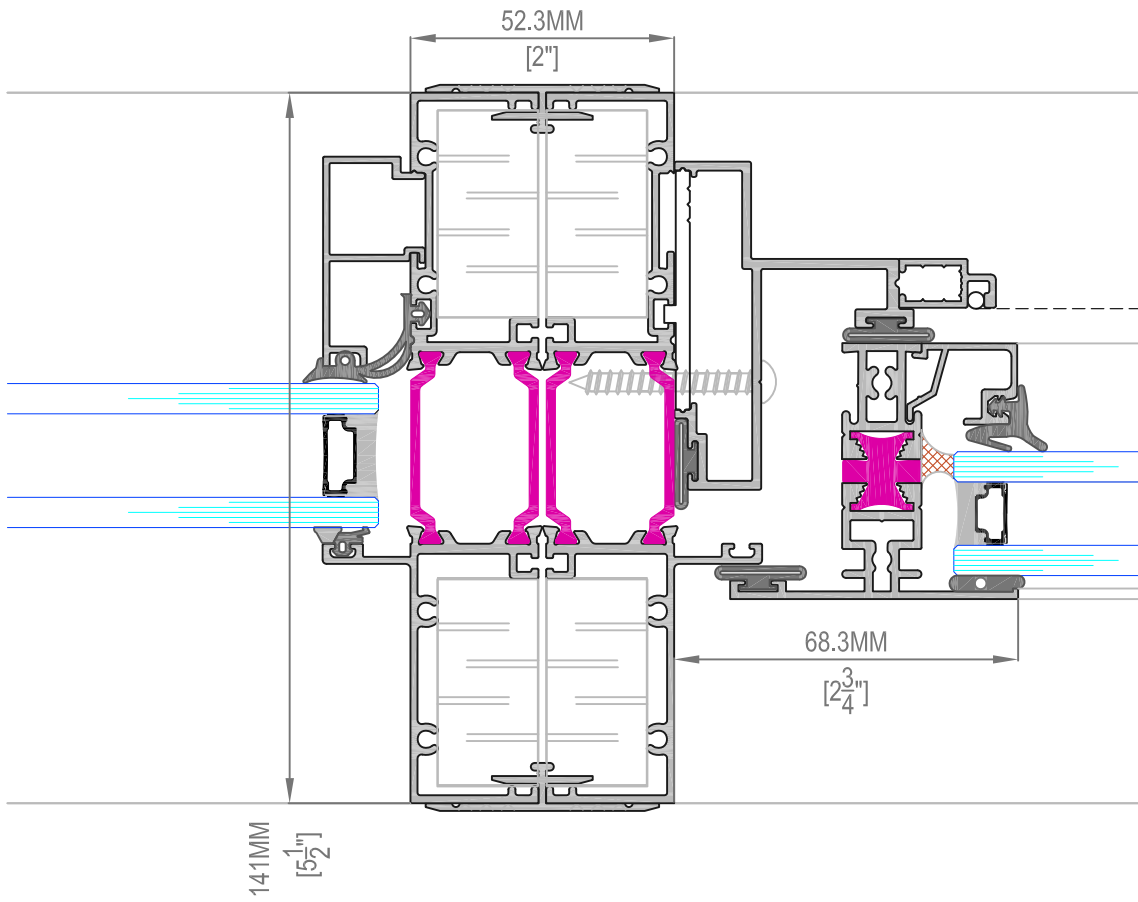

Quest

AWNING WINDOW

HEAD & SILL DETAILS

SECTION

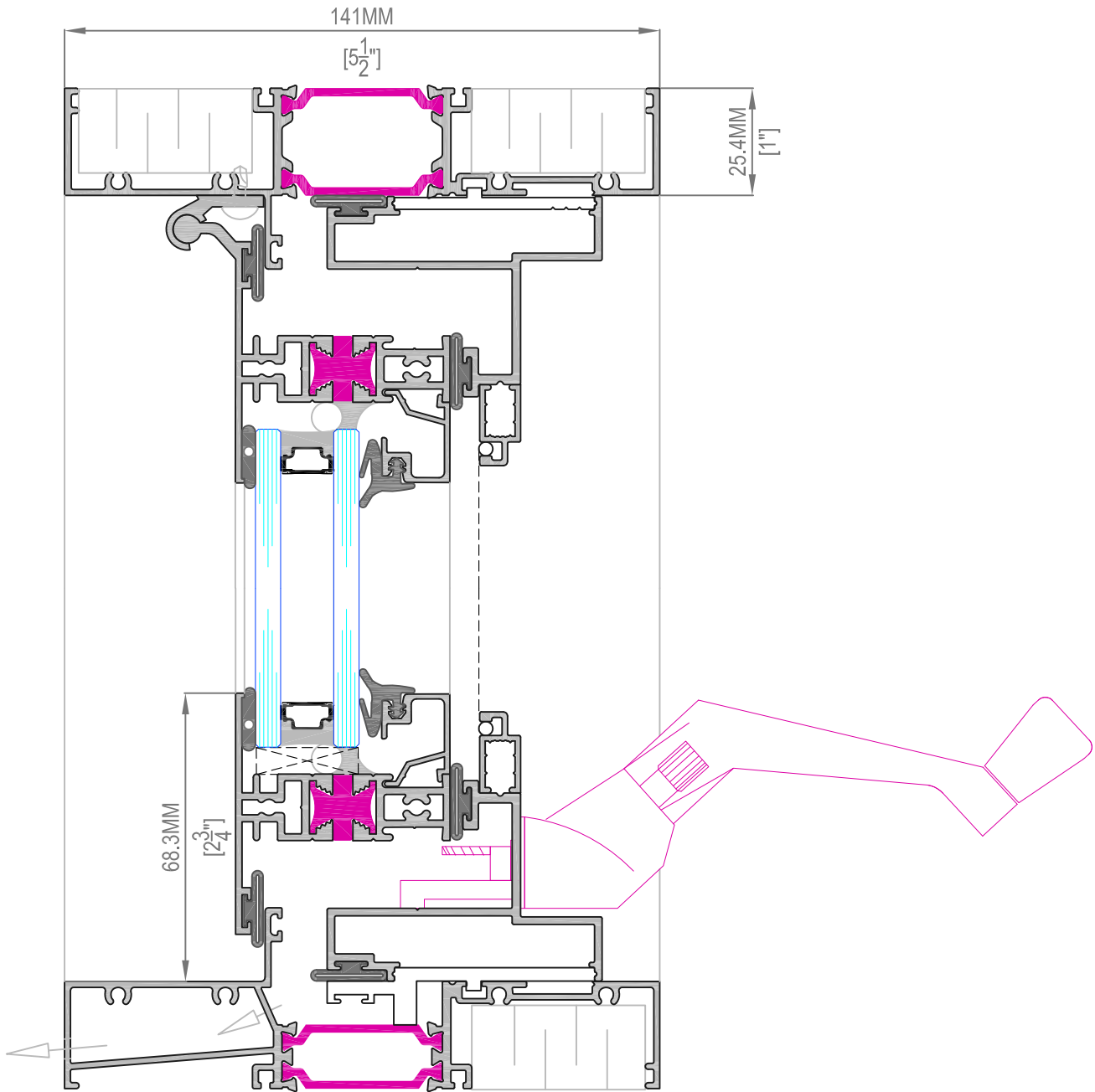

Quest

FIXED WINDOW

JAMB & COUPLER DETAILS

PLAN

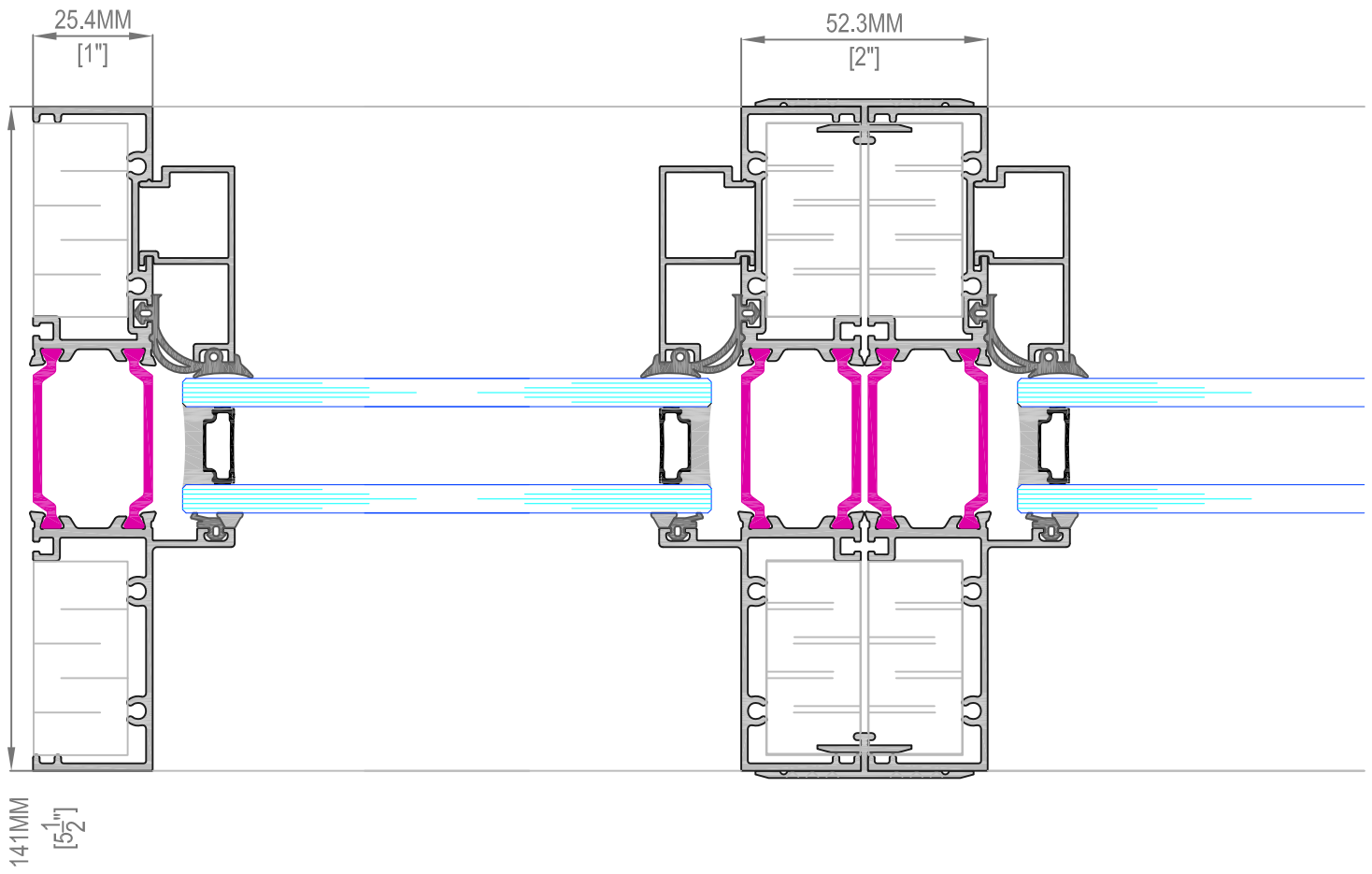

Quest

FIXED WINDOW

FLUSH PANEL & SPANDREL PANEL
JAMB & COUPLER DETAILS

PLAN

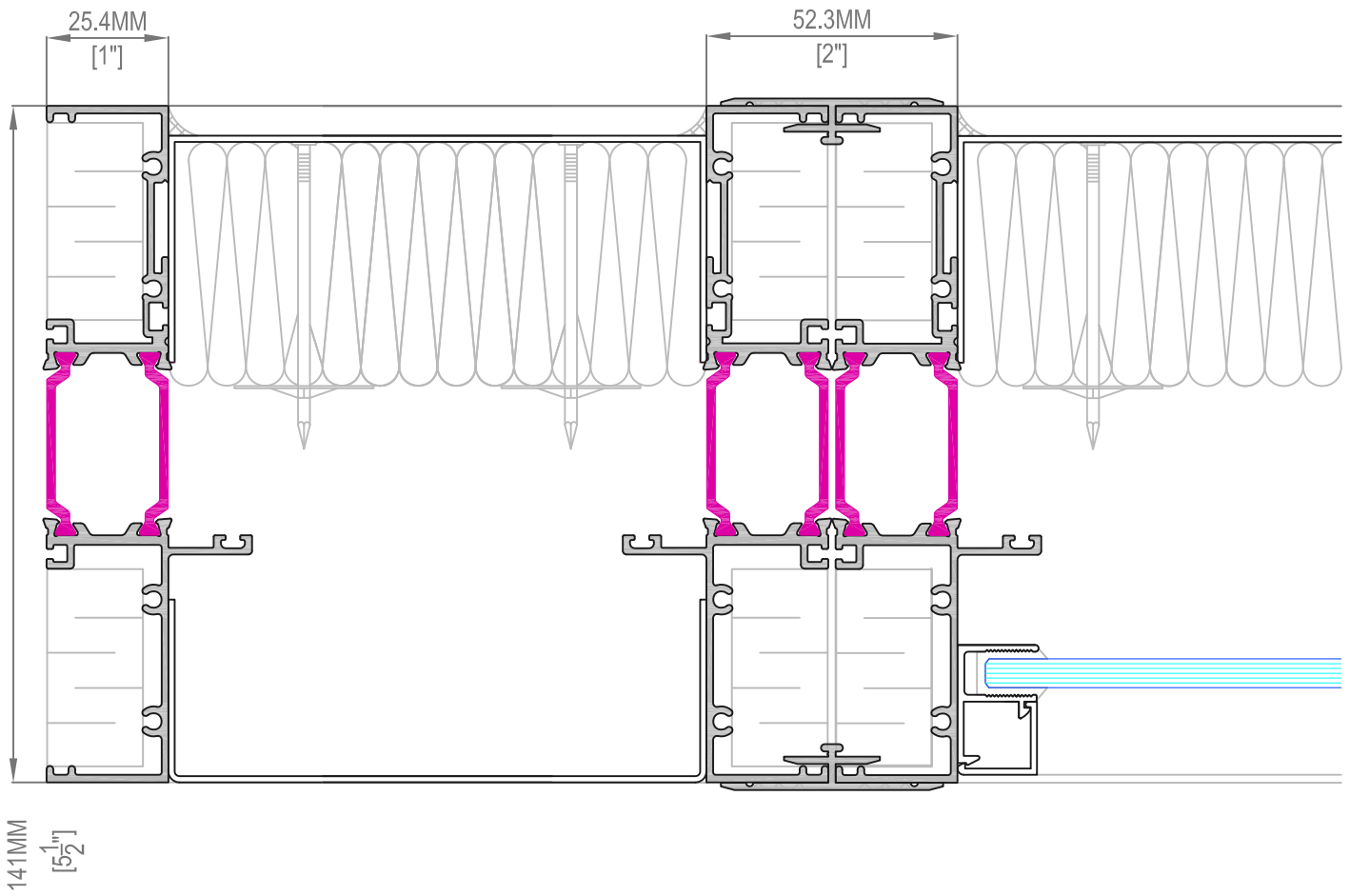

Quest

FIXED WINDOW

HEAD, MULLION & SILL DETAILS

