

ECOWALL Bypass

EW 141 / EW 141 RS
Bypass Window Guide
2015

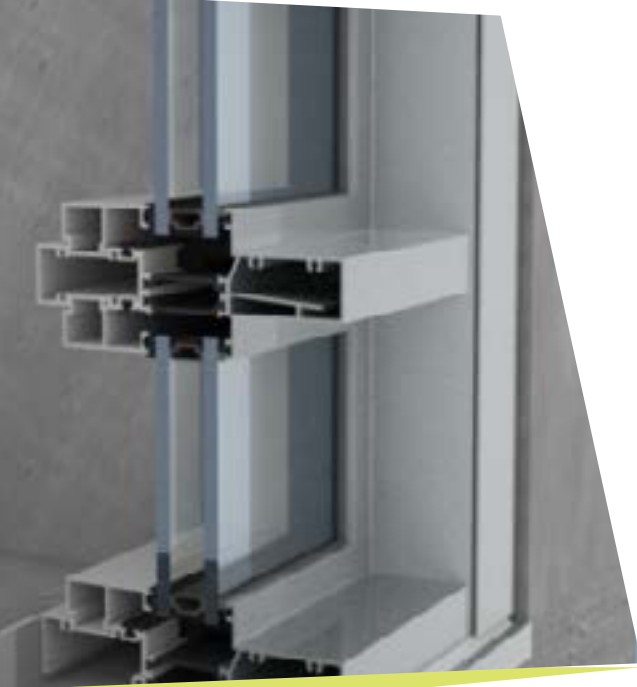

ECOWALL 'Bypass' Window

Integral Bypass

ECOWALL Slab bypass areas are integral to the frame above. They act as a rain-screen that hides the waterproofing below. Jambes run continuous into this area.

Materials

The first inch on the face of slab has a requirement for rigid insulation which when compressed prevents convection of air in this area. Aesthetically, many materials are available for this area - monolithic spandrel glass, insulated spandrel glass & metal panels. Metal panels are available in flush or projected configurations - allowing for increasing the insulating value of this critical area.

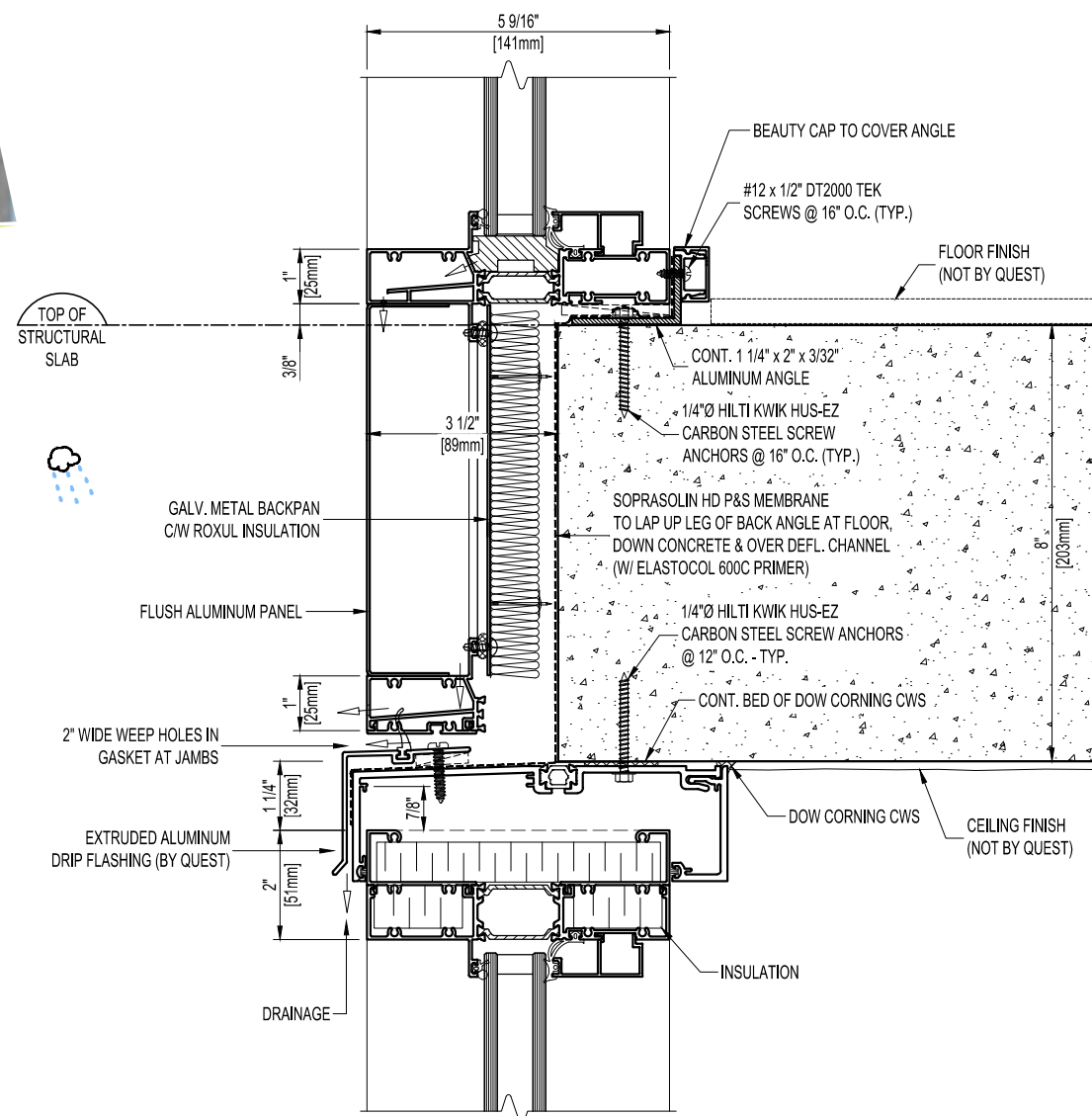

***Seismic Application**

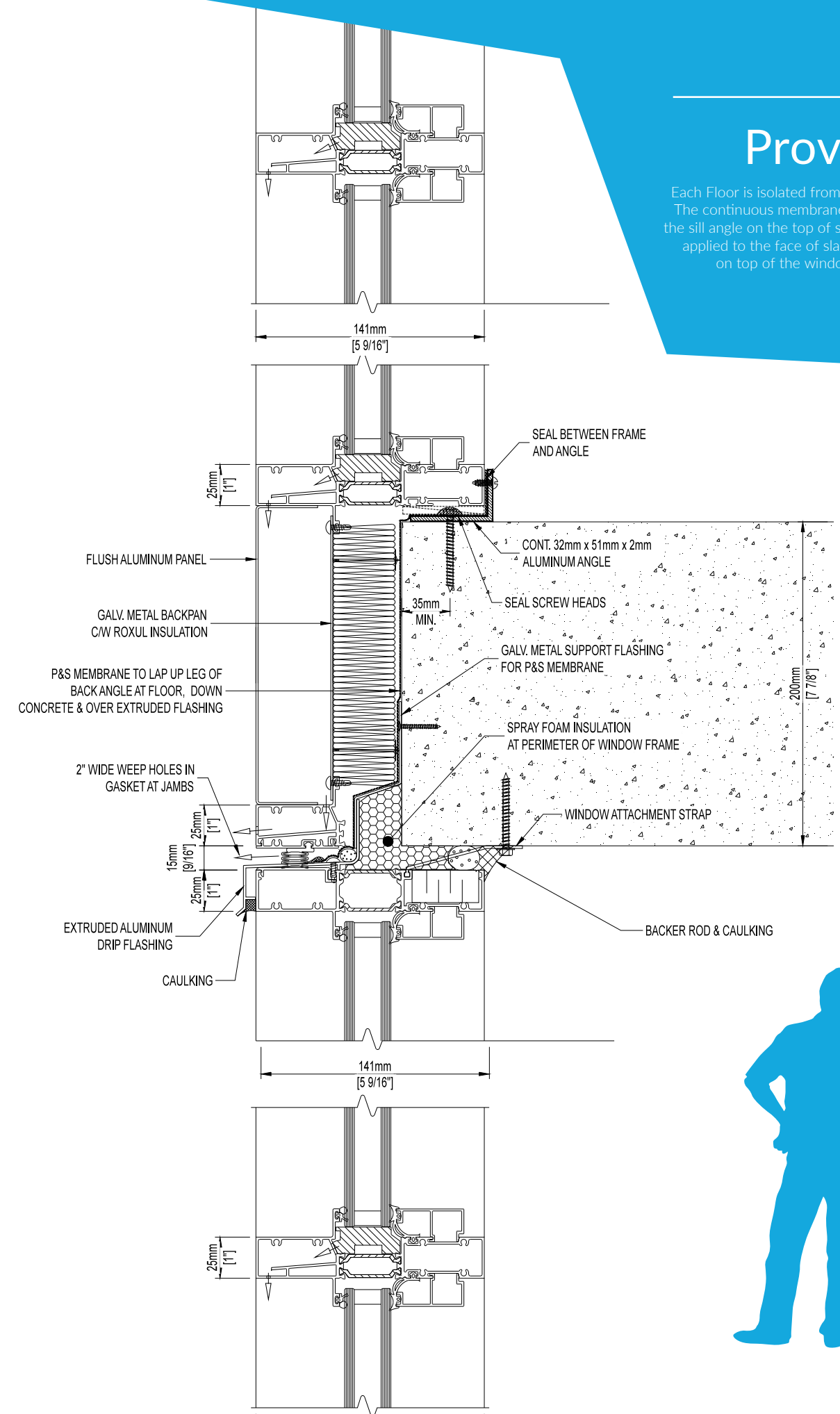

Proven.

Each Floor is isolated from the next. The continuous membrane starts at the sill angle on the top of slab and is applied to the face of slab and out on top of the window below.



Quest Window Systems, Inc.

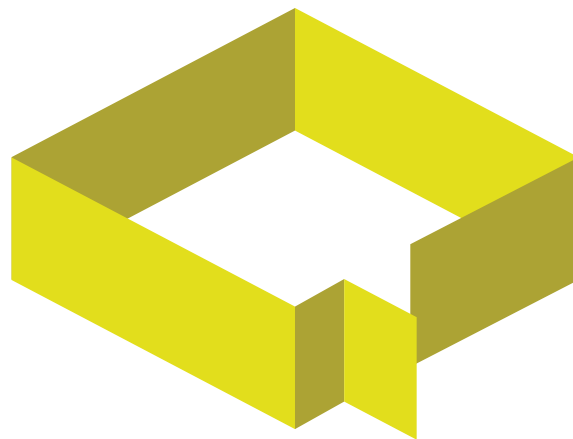

Address

6811 Goreway Drive,
Mississauga ON L4V 1L9
Canada

Contact

Local 905.851.8588
Toll-Free 1.888.851.8588
Fax 905.851.5886